

ILU GREEN HOMES

Quality Living Within Reach



ILU GREEN

THE DEVELOPER: A LEGACY OF TRUST

Neogreen Vineyard Investments Limited is the dedicated developer behind ILU Green Homes. The force behind it is anything but new.

Our leadership and executive team are composed of a consortium of Kenya's most distinguished real estate veterans. Bringing together nearly 20 years of cumulative experience, this powerhouse team has shaped the city's skyline through a steadfast commitment to quality and structural integrity.

The collective portfolio of our founders includes a prestigious array of successfully delivered projects and ongoing high-impact developments. This track record features notable projects such as Forhome Court, Valley Heights, Adorn Homes, Mogotio Oasis, and Anjoy Homes Upper Hill.

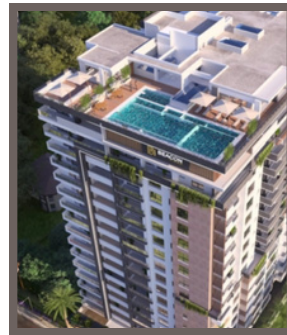
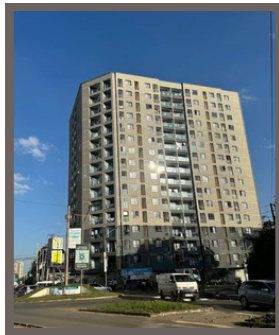

EN HOMES



THE DUALITY OF URBAN LUXURY

Situated in the east of Kilimani, the dynamic hub of Nairobi, ILU Green Homes masters the delicate balance between urban energy and personal peace.

We place you at the center of the 'Kilimani Buzz'—moments from Yaya Centre and premier business hubs. Yet, true luxury is the privilege of silence.

Uniquely nestled adjacent to the quiet campus of the International Leadership University, our location enjoys a rare, low-density breathing space protected from the city's clamor.

Designed as an eco-conscious sanctuary with rooftop gardens and an infinity pool, ILU Green Homes is more than a residence—it is your pause in the pulse of the city.



A Prime Address

Strategically located on Mito Andei Road, next to International Leadership University

SHOPPING & LEISURE

- Yaya Centre
- Hurlingham Shopping Centre
- Nairobi Arboretum
- Golf Course

Drive time
in minutes

4

3

8

8

WORK & BUSINESS

- Four Points by Sheraton
- Adlife Plaza
- Upper Hill
- CBD

2

5

8

10

HEALTH & WELLNESS

- Nairobi Women's Hospital
- The Nairobi Hospital
- Kenyatta National Hospital

3

4

8



Curated Living

Where modern convenience meets urban tranquility

Security

Perimeter Security System

24-Hour Manned Surveillance

Managed access control

Smart Lock

Secure Neighbourhood
(University and Police
Station)

Comfort

Full-Load Backup Generator for
every unit

High-Speed Lifts

Continuous Water Supply

Ample Parking

Smart Property Service App

Leisure

Lounge Area

Rooftop Pool

State-of-the-Art Fitness
Center

Kids' Play Zone

Coffee Bar & Social Hub

Private Event Space

Rooftop Pool



Coffee Bar





Gym



Gym



Kids' Play
Zone

The Residences

Thoughtfully designed layouts for modern urban living

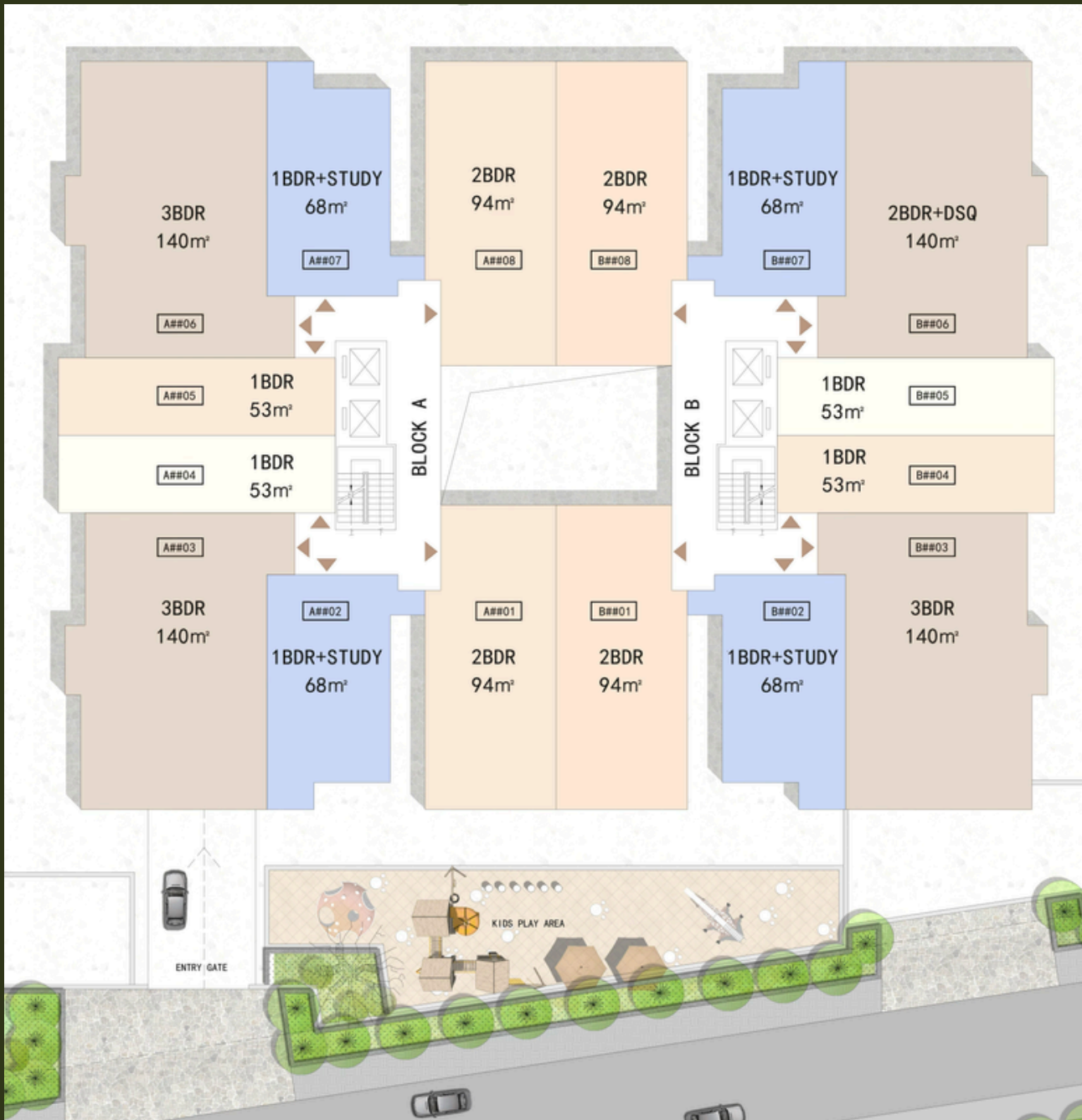

**One bedroom
(53 m²)**

A#04
A#05
B#04
B#05

**One bedroom + Study
room (68 m²)**

A#02
A#07
B#02
B#07

**Two bedrooms
(94 m²)**

A#01
A#08
B#01
B#08

**Three bedrooms
(140 m²)**

A#03
A#06
B#03

**Two bedrooms + DSQ
(140 m²)**

B#03

**Four Bedrooms
(193 m²)**

Combination of
One Bedroom
and Three
Bedrooms Units

ONE BEDROOM



53
Square Metre



1



1



1

ONE BEDROOM+ STUDY ROOM



68
Square Metre



2



1



1

TWO BEDROOMS



94
Square Metre



2



2



2

TWO BEDROOMS+ DSQ



140
Square Metre



3



3



4

THREE BEDROOMS



140
Square Metre



3



2



4

FOUR BEDROOMS



193
Square Metre



Premium Specifications

Where uncompromising quality meets timeless elegance

- **Flooring** Premium polished tiles in living areas; Non-slip matte finish in wet areas
- **Walls** Plaster and silk-finish paint
- **Ceiling** Elegant and designer gypsum detailing
- **Lighting** Modern ceiling-mounted light fixtures fitted in all rooms. (Decorative chandeliers and pendant lights are not included.)

-
- **Appliances** Built-in hob and smoke extractor.
 - **Curtain** Side-opening, fabric/drapes with sheer
 - **Wardrobes** Full height melamine cabinetry

-
- **Electric Fittings** ISO Standard high-quality switches and sockets (Schneider/Chint or equivalent).

- **Windows** Powder-coated aluminium frame with glass
- **Doors** Laminated main door with smart lock; Veneer-faced MDF doors to living areas; Glass doors to bathrooms and balconies
- **Kitchen** Modern high-gloss / textured cabinetry with soft-close mechanism.

-
- **Balcony** Modern Steel & Safety Railings
 - **Bathroom** Modern sanitary ware; Shower partition; Overhead shower; Towel rails, toilet roll holder and shower shelf

Standard handover specifications include the items listed above. The developer reserves the right to substitute materials with equivalent quality without prior notice.